

SURVEYOR



LEGEND GRAND



FOREST RIVER

FORESTRIVERINC.COM

SURVEYOR SUB-4,000 LB.

Our Sub-4 series starts at under 4,000 lbs dry.
Lightweight, compact, and designed to take you beyond the path, so you can leave the trail.

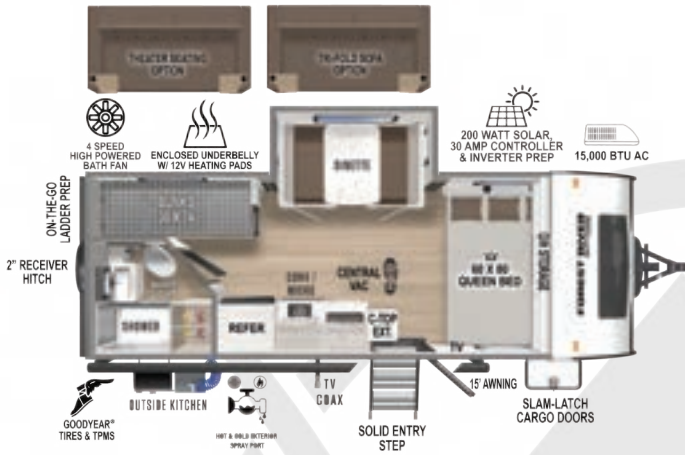

19BHLE	UVW	HITCH	CCC	LENGTH*	HEIGHT**	CAPACITY (GAL)
	3,777	408	1,833	23' 7"	10' 9"	30 30 30

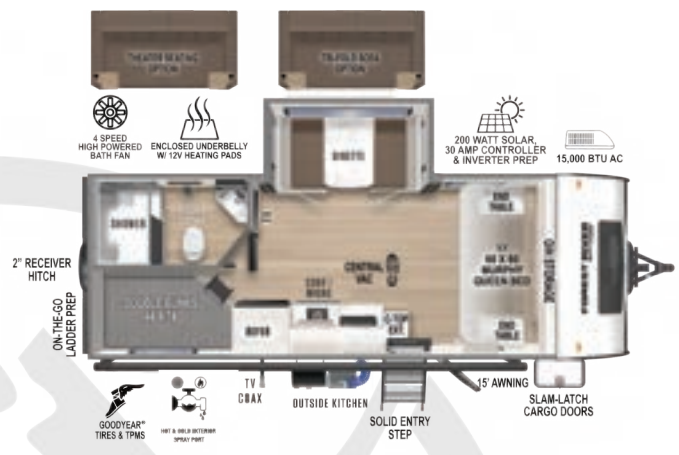

19MDBLE	UVW	HITCH	CCC	LENGTH*	HEIGHT**	CAPACITY (GAL)
	4,081	470	1,598	23' 7"	10' 9"	30 30 30

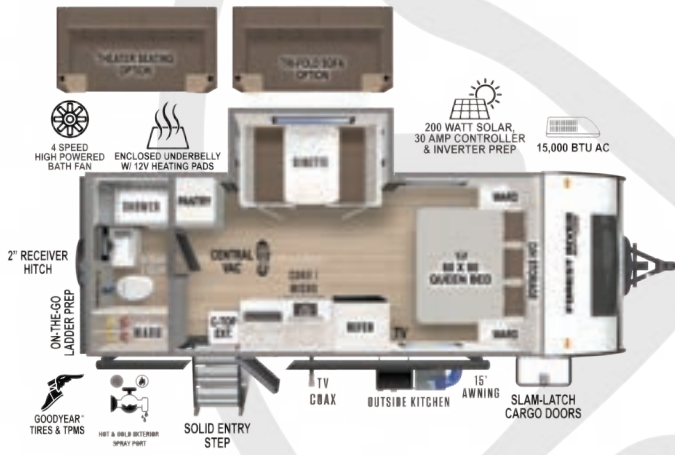

19RBLE	UVW	HITCH	CCC	LENGTH*	HEIGHT**	CAPACITY (GAL)
	3,917	449	1,732	23' 7"	10' 9"	30 30 30

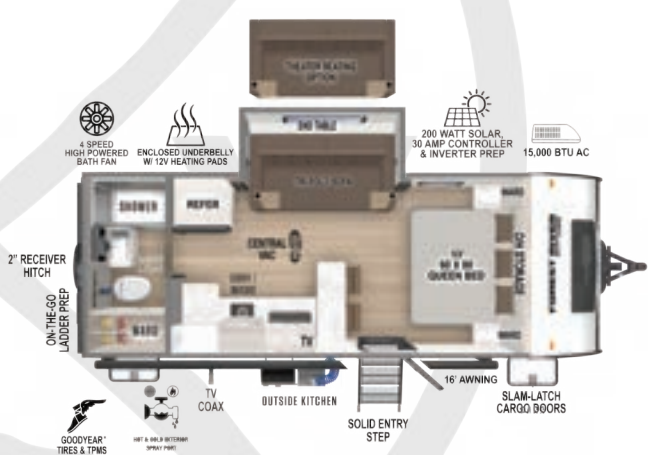

19SSLE	UVW	HITCH	CCC	LENGTH*	HEIGHT**	CAPACITY (GAL)
	4,128	425	1,497	24' 4"	10' 9"	30 30 30

*Length Coupler to Bumper **Height Top Of A/C



19BHLE



19RBLE



19SSLE

TOP FEATURES



PLATFORM ENTRY
STEPS
W/ NIGHTLIGHT



ENCLOSED UNDERBELLY
W/ FORCED HEAT &
RADIANT FOIL INSULATION



12V HEATING PADS
ON ALL TANKS



60X80 RESIDENTIAL
QUEEN BED



10 CU. FT. 12V
REFRIGERATOR



PREMIUM WINDOW
TREATMENTS



ON DEMAND
TANKLESS
WATER HEATER

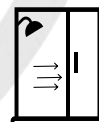

UPGRADED SHOWER
ENCLOSURE



2" REAR ACCESSORY HITCH



GOOD YEAR® TIRES



TIRE PRESSURE
MONITORING SYSTEM



15,000 BTU A/C



200 WATT SOLAR PANEL
30 AMP CONTROLLER
& INVERTER PREP



OUTSIDE KITCHEN



CENTRAL VACUUM
SYSTEM



ULTIMATE BEDROOM
STORAGE



TALLER CEILING
& SLIDE OUT HEIGHT



USB-C PORTS
INSIDE & OUT



CONVENIENT MOTION
LIGHTING
INSIDE & OUT



21" OVENS
N/A SINGLE AXLES



4 SPEED HIGH POWERED
BATH FAN



HOT & COLD EXTERIOR
SPRAY PORT



ELECTRIC FIREPLACE
SELECT MODELS



SLAM LATCH
CARGO DOORS

SURVEYOR LEGEND

Our Legend series delivers a full line of innovative, half-ton towable floorplans that are designed without compromise, so that you can keep exploring and still have the comforts of home.

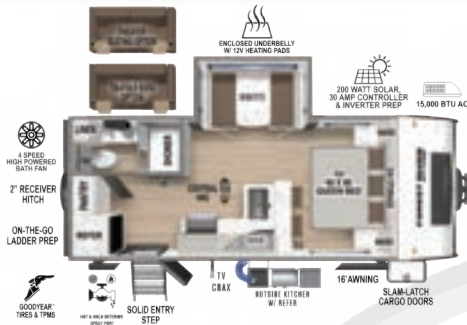

202RBLE	UVW	HITCH	CCC	LENGTH*	HEIGHT**	CAPACITY (GAL)		
	4,931	497	2,566	25' 1"	11' 3"	40	40	30

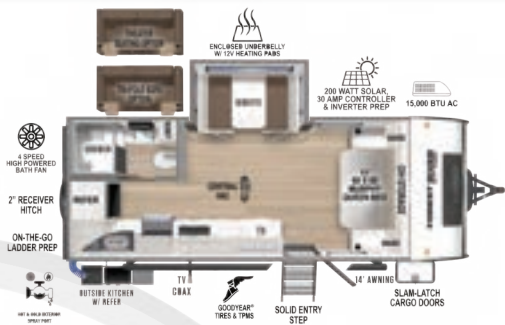

203RBLE	UVW	HITCH	CCC	LENGTH*	HEIGHT**	CAPACITY (GAL)		
	5,030	577	2,547	25' 1"	11' 3"	40	40	30

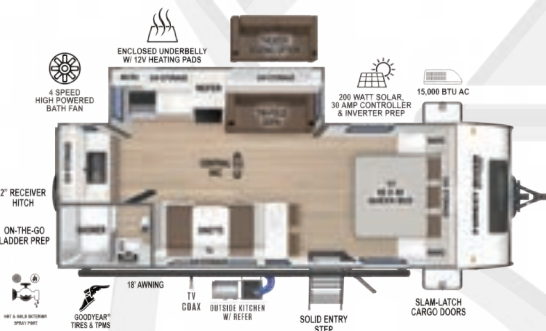

204MKLE	UVW	HITCH	CCC	LENGTH*	HEIGHT**	CAPACITY (GAL)		
	5,493	550	2,057	27' 0"	TBD	40	30	30

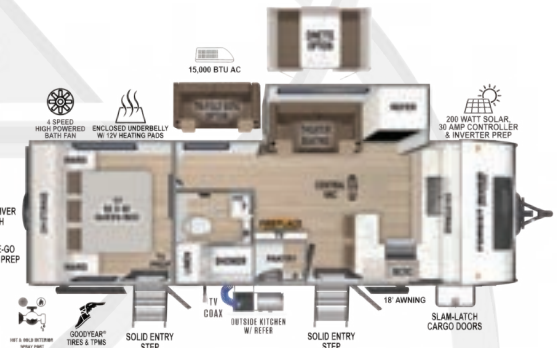

235FKLE	UVW	HITCH	CCC	LENGTH*	HEIGHT**	CAPACITY (GAL)		
	6,108	705	1,597	30' 0"	11' 3"	40	40	30



252RBLE	UVW	HITCH	CCC	LENGTH*	HEIGHT**	CAPACITY (GAL)		
	5,313	590	2,277	29' 7"	11' 3"	40	40	30



260BHLE	UVW	HITCH	CCC	LENGTH*	HEIGHT**	CAPACITY (GAL)		
	5,778	740	1,962	29' 11"	11' 3"	40	40	30

*Length Coupler to Bumper **Height Top Of A/C



202RBLE



260BHLE



261RKLE	UVW	HITCH	CCC	LENGTH*	HEIGHT**	CAPACITY (GAL)		
	TBD	TBD	TBD	30' 0"	11' 3"	40	60	30

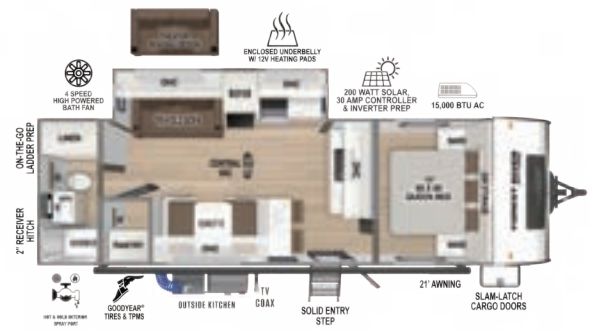

265RBLE	UVW	HITCH	CCC	LENGTH*	HEIGHT**	CAPACITY (GAL)		
	6,158	715	1,557	30' 9"	11' 3"	40	60	30

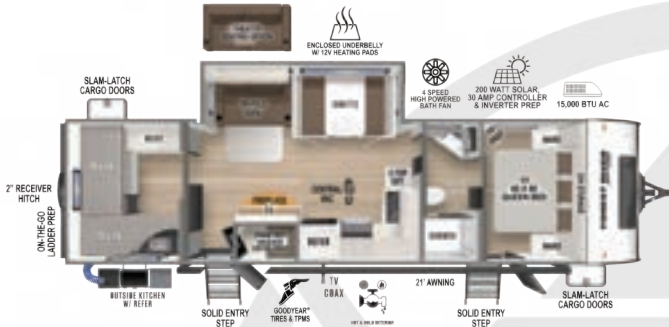

296QBLE	UVW	HITCH	CCC	LENGTH*	HEIGHT**	CAPACITY (GAL)		
	6,806	804	2,796	35' 1"	11' 3"	40	40	30



303BHLE	UVW	HITCH	CCC	LENGTH*	HEIGHT**	CAPACITY (GAL)		
	7,743	860	1,917	37' 11"	11' 3"	40	60	60



204MKLE



265RBLE

TOP FEATURES



PLATFORM ENTRY
STEPS
W/ NIGHTLIGHT



ENCLOSED UNDERBELLY
W/ FORCED HEAT &
RADIANT FOIL INSULATION



12V HEATING PADS
ON ALL TANKS



60X80 RESIDENTIAL
QUEEN BED



10 CU. FT. 12V
REFRIGERATOR



PREMIUM WINDOW
TREATMENTS



ON DEMAND
TANKLESS
WATER HEATER

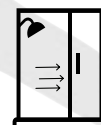

UPGRADED SHOWER
ENCLOSURE



2" REAR ACCESSORY HITCH



GOODYEAR® TIRES



TIRE PRESSURE
MONITORING SYSTEM

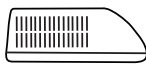

15,000 BTU A/C

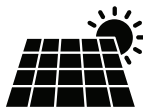

200 WATT SOLAR PANEL
30 AMP CONTROLLER
& INVERTER PREP



OUTSIDE KITCHEN



CENTRAL VACUUM
SYSTEM



ULTIMATE BEDROOM
STORAGE



TALLER CEILING
& SLIDE OUT HEIGHT



USB-C PORTS
INSIDE & OUT



CONVENIENT MOTION
LIGHTING
INSIDE & OUT



21" OVENS
N/A SINGLE AXLES



4 SPEED HIGH POWERED
BATH FAN



HOT & COLD EXTERIOR
SPRAY PORT



ELECTRIC FIREPLACE
SELECT MODELS



SLAM LATCH
CARGO DOORS

GRAND SURVEYOR

The Grand Surveyor series delivers a turn-key, 5-Star Resort feel to your outdoor adventure. With even more standard features, and a head-turning lineup of half-ton towable floorplans, we'll have you living Grand while others try to Glamp.



253RLS	UVW	HITCH	CCC	LENGTH*	HEIGHT**	CAPACITY (GAL)		
	6,368	815	1,447	31' 9"	11' 3"	40	40	30

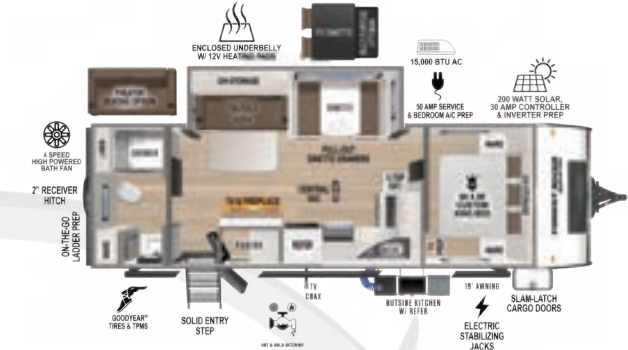

267RBSS	UVW	HITCH	CCC	LENGTH*	HEIGHT**	CAPACITY (GAL)		
	6,063	615	1,552	30' 7"	11' 3"	40	60	30

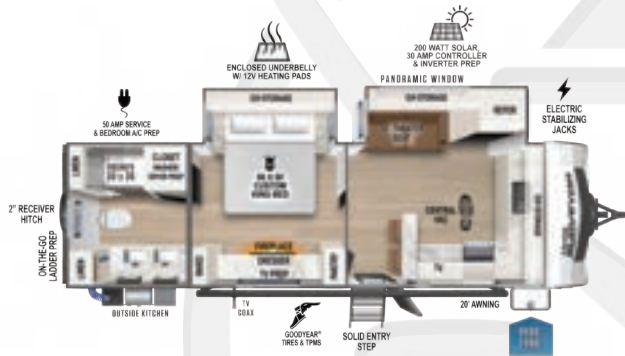

268FKBS	UVW	HITCH	CCC	LENGTH*	HEIGHT**	CAPACITY (GAL)		
	7,133	920	2,587	32' 0"	11' 3"	40	60	30

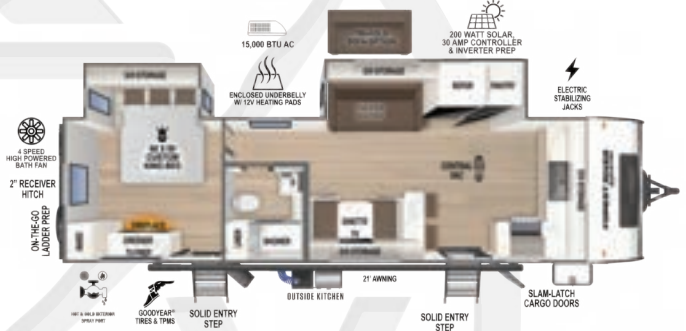

275FKBS	UVW	HITCH	CCC	LENGTH*	HEIGHT**	CAPACITY (GAL)		
	7,123	845	1,500	32' 8"	TBD	40	60	30



301RKBS	UVW	HITCH	CCC	LENGTH*	HEIGHT**	CAPACITY (GAL)		
	8,343	845	2,902	38' 10"	TBD	40	60	30



302RDBS	UVW	HITCH	CCC	LENGTH*	HEIGHT**	CAPACITY (GAL)		
	8,838	955	2,517	38' 10"	TBD	40	60	30

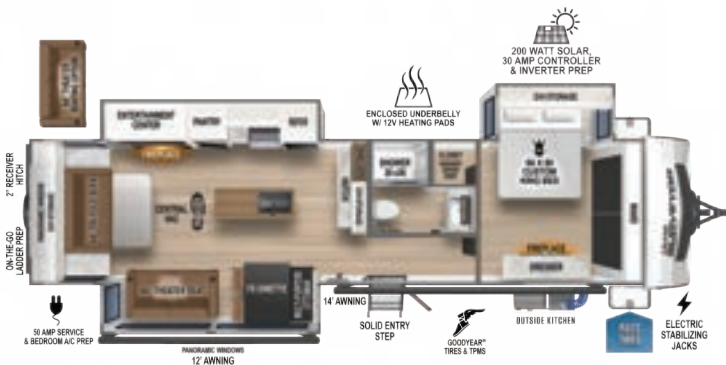

305RLBS	UVW	HITCH	CCC	LENGTH*	HEIGHT**	CAPACITY (GAL)		
	8,793	892	899	38' 10"	TBD	40	60	30



268FKBS



TOP FEATURES



PLATFORM ENTRY
STEPS)
W/ NIGHTLIGHT



ENCLOSED UNDERBELLY
W/ FORCED HEAT &
RADIANT FOIL INSULATION



12V HEATING PADS
ON ALL TANKS



CUSTOM KING
SIZE BED



10 CU. FT. 12V
REFRIGERATOR



PREMIUM WINDOW
TREATMENTS



GOODYEAR® TIRES



21" OVENS
N/A SINGLE AXLES



4 SPEED HIGH POWERED
BATH FAN



HOT & COLD EXTERIOR
SPRAY PORT



TIRE PRESSURE
MONITORING SYSTEM

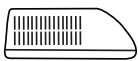

15,000 BTU A/C



200 WATT SOLAR PANEL
30 AMP CONTROLLER
& INVERTER PREP



OUTSIDE KITCHEN



CENTRAL VACUUM
SYSTEM



ON DEMAND
TANKLESS
WATER HEATER



ELECTRIC FIREPLACE



SLAM LATCH
CARGO DOORS



50 AMP SERVICE
& BEDROOM A/C PREP

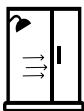

UPGRADED SHOWER
ENCLOSURE



2" REAR ACCESSORY HITCH



ULTIMATE BEDROOM
STORAGE



TALLER CEILING
& SLIDE OUT HEIGHT



USB-C PORTS
INSIDE & OUT



CONVENIENT MOTION
LIGHTING
INSIDE & OUT



ELECTRIC
STABILIZER JACKS

SURVEYOR

SUPERIOR CONSTRUCTION

1 Laminated Sidewalls, Rear Wall, Slide-Outs & Floor

- Solid Wall Construction
- Block Foam Insulated
- Superior Durability

2 Azdel Composite Sidewalls, Rear Wall, Front Wall, & Slide-Outs

- Replaces Plywood Used by Competing Brands
- Water Resistant Material
- Helps Prevent Rot, Mold, & Delamination
- Increases Insulation Values

3 Superior Aluminum Structure

- Welded Aluminum Framing Around All Openings
- Lighter Weight Than Competing Brands – True Half-Ton Towable
- Stronger & Better Constructed

4 Fully Walkable Roof w/ Industry Best PVC Membrane

- 16" On-Center Trusses, Plywood Decking & Residential Insulation
- 15 Year Warranty On PVC Membrane
- No Treatments Required On PVC – Saves Time & Money

5 Extended Season Ready

- 2" Aluminum Framed Floor with Block Foam Insulation
- Underbelly Sealed and Insulated with Radiant Foil
- Forced Heat to Underbelly Through Dedicated Duct
- Heated Holding Tanks with 12V Heating Pads



SCAN ME
FOR MORE
CONSTRUCTION
DETAILS



PRE-DELIVERY INSPECTION FACILITY

20,000 square feet of quality assurance. The bare essentials for a premium product. This state-of-the-art facility gives immediate daily feedback to production for quality assurance in every unit built.



Download our Forest River mobile app or visit our dynamic online manual to enhance your ownership experience. These interactive options provide incredible ease and insight into use, maintenance and enjoyment of your Forest River product.

Ranging from "How-To" videos, pictures and illustrations of various components, systems and features, to fully searchable content and downloadable PDFs for individual component owner's manuals, answers are always just a click away. View the online manual at www.forestriverinc.com/OnlineManual or download our FREE app from the App Store or Google Play!



GVWR (Gross Vehicle Weight Rating) - is the maximum permissible weight of the unit when fully loaded. It includes all weights, inclusive of all fluids, cargo, optional equipment and accessories. For safety and product performance do NOT exceed the GVWR.

GAWR (Gross Axle Weight Rating) - is the maximum permissible weight, including cargo, fluids, optional equipment and accessories that can be safely supported by a combination of all axles.

UVW (Unloaded Vehicle Weight)* - is the typical weight of the unit as manufactured at the factory. It includes all weight at the unit's axle(s) and tongue or pin and LP Gas. The UVW does not include cargo, fresh potable water, additional optional equipment or dealer installed accessories.

CCC (Cargo Carrying Capacity)** - is the amount of weight available for fresh potable water, cargo, additional optional equipment and accessories. CCC is equal to GVWR minus UVW. Available CCC should accommodate fresh potable water (8.3 lbs per gallon). Before filling the fresh water tank, empty black and gray tanks for more cargo capacity.

**Estimated Average based on standard build optional equipment. ** Estimated average based on standard build optional equipment. Values estimated at time of printing.*

Each Forest River RV is weighed at the manufacturing facility prior to shipping. A label identifying the unloaded vehicle weight of the actual unit and the cargo carrying capacity is applied to every Forest River RV prior to leaving our facilities. The load capacity of your unit is designated by weight, not by volume, so you cannot necessarily use all available space when loading your unit.

All information contained in this brochure is believed to be accurate at the time of publication. However, during the model year, it may be necessary to make revisions and Forest River, Inc., reserves the right to make all such changes without notice, including prices, colors, materials, equipment and specifications as well as the addition of new models and the discontinuance of models shown in this brochure. Therefore, please consult with your Forest River, Inc., dealer and confirm the existence of any materials, design or specifications that are material to your purchase decision.

©2024 Surveyor, a division of Forest River Inc., a Berkshire Hathaway company.

FREE MEMBERSHIP
to Forest River Owners' Group

www.forestriverfrog.com



Learn More
Scan this barcode using a QR Reader on your smart phone to learn more about Forest River.



**24/7 EMERGENCY
ROADSIDE ASSISTANCE
WITH VEHICLE PURCHASE***

TOWING
JUMP-STARTS
TIRE CHANGES
FLUID DELIVERY
LOCKOUT
SERVICE

WINCH-OUT
MOBILE MECHANIC
TECHNICAL
SUPPORT
DEALER LOCATOR
SERVICES

**SPECIALIZED
DISPATCH SERVICES**

*VALID FOR 1 YEAR FROM DATE OF PURCHASE